

First Floor Layout

River Road Church, Baptist

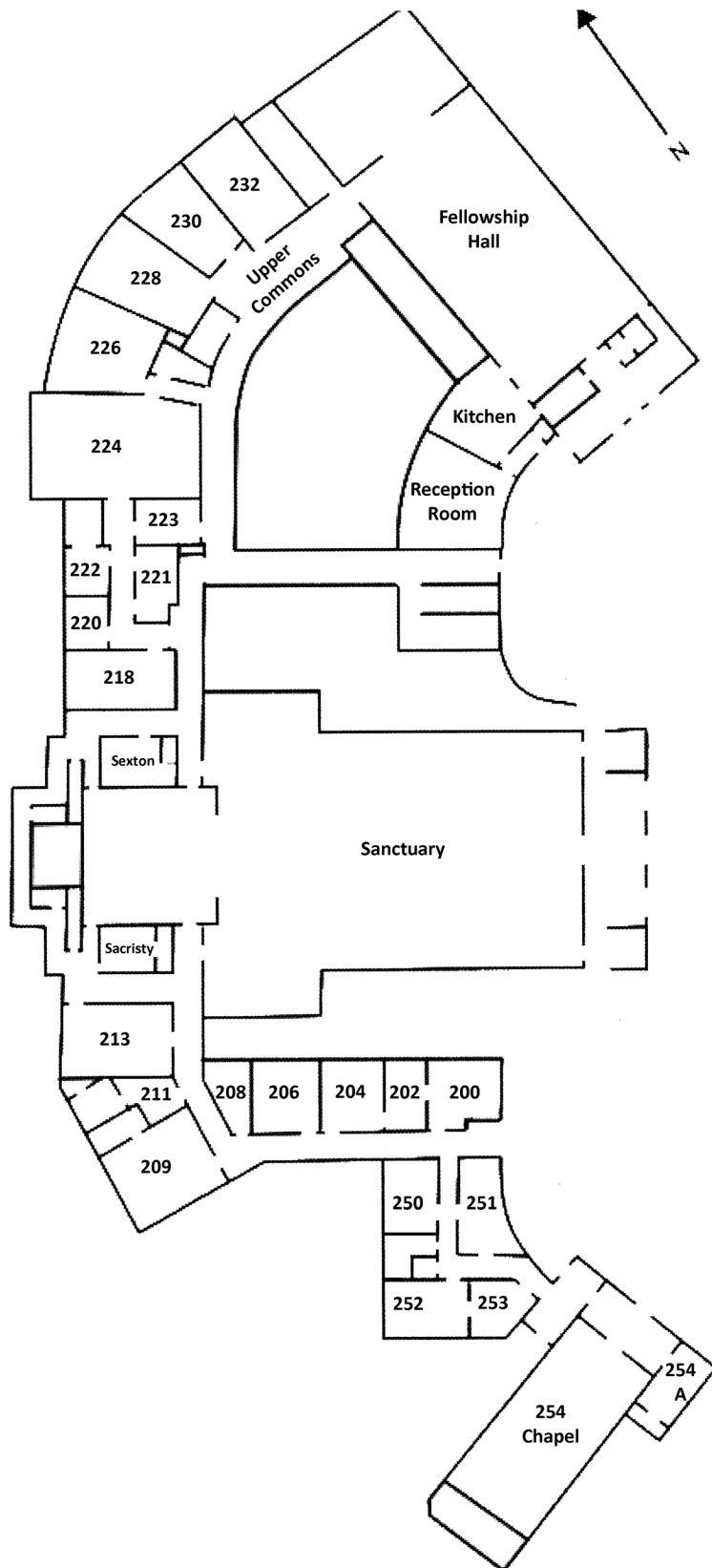

Rooms

- 200 Church Office**
Susan Young | susanyoung@rrcb.org
Terri McMahon | terrimcmahon@rrcb.org
- 202 Workroom**
- 204 Minister of Administration**
Daniel Ingram | danielingram@rrcb.org
- 206 Church Archives**
- 208 Minister of Pastoral Care**
David Breckenridge | david@rrcb.org
- 209 Pastor**
Daniel Glaze | danielglaze@rrcb.org
- 211 Communications Specialist**
Cassandra Ducca | cassandrducca@rrcb.org
- 213 Parlor**
- 218 Bell Choir Room**
Chancel Bell Choir
- 220 Minister of Music**
Bob Gallagher | bobgallagher@rrcb.org
- 221 Women's Robing Room**
- 222 Music Library**
- 223 Men's Robing Room**
- 224 Main Choir Room**
Chancel Choir
River Road Camerata
Crusader Choir
Voice for Life
- 226 Youth Choir Room**
Youth Choir
Carol Choir
- 228 Friendship Class**
TFC-Kids
- 230 Life Class**
- 232 New Horizons Class**
Cherub Choir
TFC-Kids
- 250 Office Manager**
LeAnne Lane | leannelane@rrcb.org
- 251 Associate Pastor
for Adult Discipleship**
Anna Perry Miller | anna@rrcb.org
- 252 Associate Pastor
to Youth & Their Families**
Marnie Fisher-Ingram | marnie@rrcb.org
- 253 Minister to Children**
Sandy Rooney | sandyrooney@rrcb.org
- 254 Chapel**
- 254A Bride's Room**

Ground Floor Layout River Road Church, Baptist

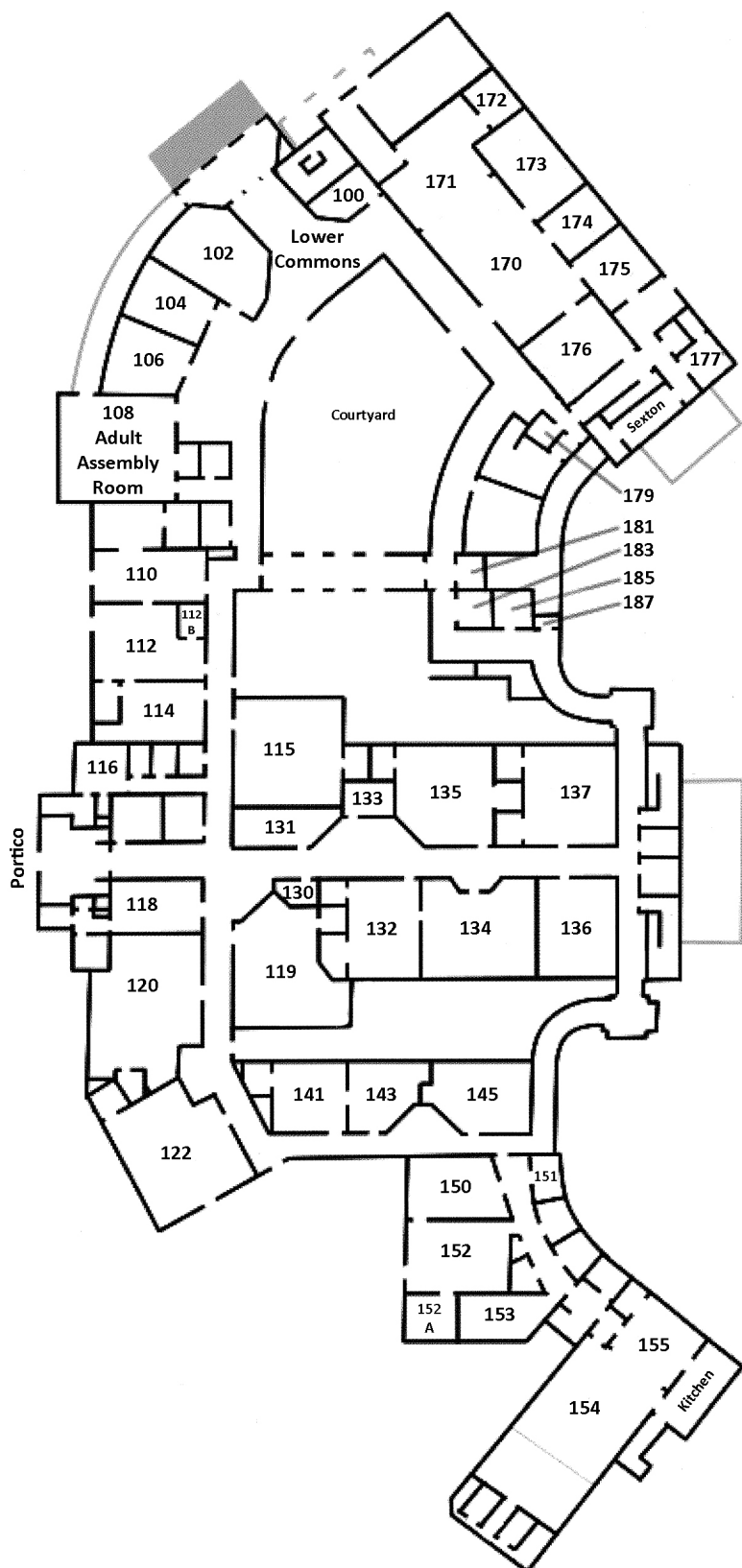

Rooms

- 100** Sunday School Office
- 102** Shepherd-Holland Bible Study Class
- 104** Faith Walk Class
- 106**
- 108** **Adult Assembly Room**
Robert Smart Class
- 110** **Nursery**
WorshipCare & Childcare
- 112** **Preschool I: 2- and 3-year-old**
WorshipCare & Childcare
- 116** **Preschool Development Center Resource Room**
- 118** **Preschool Development Center Office**
Danielle Simon
danielle@riverroadpreschool.org
Beth Howe
bethhowe@riverroadpreschool.org
- 120** **Kindergarten**
WorshipCare & Sunday School
- 122** **Preschool II: 4-year-olds & Pre-K**
WorshipCare & Sunday School
- 131** **Preschool Development Center Resource Library**
- 132** **Grade 5**
Sunday School
- 133** **Kitchen**
- 134** **Grades 3-4**
Sunday School
- 135** **Grades 1-2**
Sunday School
- 145** **Discovery Class**
- 154-155** **Chapel Hall**
- 170-176** **Youth Area**
- 173** **High School**
Sunday School
- 175** **Middle School Girls**
Sunday School
- 176** **Middle School Boys**
Sunday School